



Perfect Cue



Model PC-433SYS



PerfectCue is programmable!

Visit www.dsan.com/PerfectCue to download programmer application.

Assign any keystroke, macro or no keystroke to any button.

Introduction

PerfectCue is a light and sound signaling system. It enables a speaker to send cues to a projectionist for "next", "back" and "screen blank" using a wireless hand-held actuator.

PerfectCue is a versatile event-staging tool. It uses high data rate RF protocol that provides fast responses to the wireless actuator. It contains different types of jacks that make easy hard-wire back-up connections with Cat 5, XLR, EBY or twisted pair cable. These provide for simple interface with other wireless control systems or custom devices.

Multiple cue lights can be "daisy-chained" on a single cable carrying both data and power yet they may be operated independently on separate communication channels.

A built-in keyboard emulator enables PerfectCue to remotely control presentation applications such as PowerPoint® via USB connection.

Important Information

Warranty

Instruments made by D'San Corporation are warranted against defects in materials and workmanship for one year from date of shipment. Any instrument which fails will be restored free of charge. D'San will determine whether the failure was the result of defect or user negligence.



Jacks are to be used only for the connections as described in this guide.



This device complies for F.C.C. Rules part 15. Operation is subject to the following two conditions: 1) This device may not cause harmful interference and 2) this device must accept any interference that may cause undesired operation.

PowerPoint is a trademark of Microsoft Corporation.



D'SAN CORPORATION
Roslyn Heights, NY 11577
Tel: 516 625-5608 Fax: 516 625-0878
Internet: www.dsan.com
Email: info@dsan.com

Settings and Connections

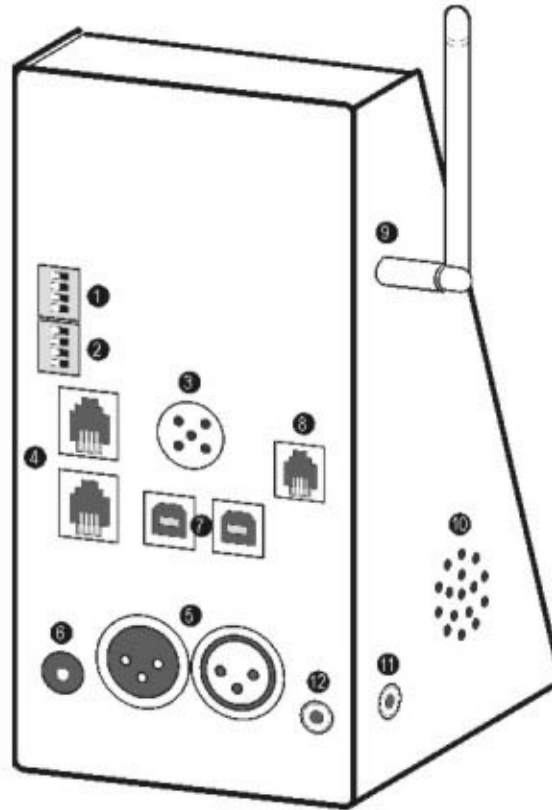

1 UNIT ID

Activate / isolate multiple cue lights on a single line. Units can be set to respond to 1, 2, 3 or 4 other units.



2 CHANNEL

Set for multi-unit proximate use. 16 channels available. Match channel on cue light and actuator.



3 EBY JACK

Connect hand-held actuator for hard-wire backup.

4 RJ45 JACK

For Cat 5 cable

5 XLR JACK

For standard microphone cable.

! Caution !

Cables carry data and power. Use for connection to other cue lights only! Do not connect to audio equipment.

6 POWER

Use D'San-supplied 12-volt AC power wall plug transformer with center pin (+) positive **only**. Note: Jack is recessed to help keep plug from coming out.

7 USB PORTS "A" AND "B"

For direct computer connection. Cue light sends keystrokes "Right Arrow," "Left Arrow" and "B."

8 RJ11 JACK

Connect any low-power (< 100mA) light box standard telephone wire with modular connector. Drive higher voltage devices through relays.

9 ANTENNA

Rotate in two planes for better reception.

10 SPEAKER

Plays selected cue sounds.

11 HEADPHONE OUTPUT

Accepts stereo phono plug. Operates independently of onboard speaker. Combines cue sounds with audio monitor input (12) with matched volume.

12 MONITOR AUDIO INPUT

Accepts stereo phono plug. Allows operator to monitor stage presentation through Headphone Output (11).

Controls

Dimensions:
6.5"(H), 4.0"(D), 3.4"(W).

Weight: 10.7 oz.

Convenient 1/4-20 tripod mount
on bottom.

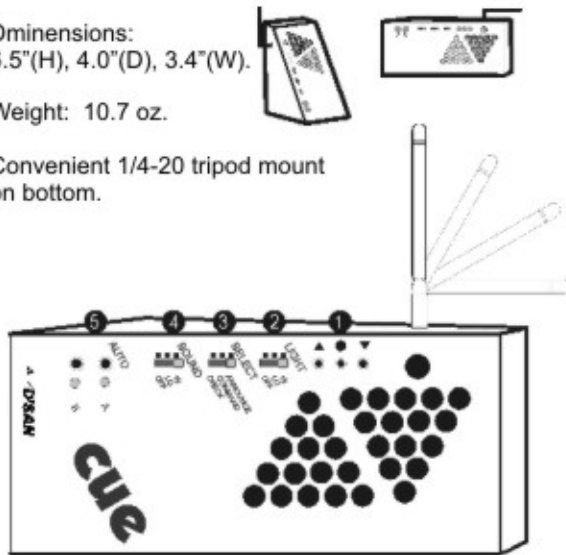

1 LOCAL ACTUATORS

Activate lights on connected units

- ▶ Green (Next)
- Yellow (Screen blank)
- ◀ Red (Back)

2 LIGHT

Control brightness. Hi. Lo. Off.

3 SELECT

Unique cues for Next, Back, Screen blank.

CHECK ● ●

A brief local alert

COMMAND ● ● ●...

Intrusive prompt

ANNOUNCE ● ●... ● ●...

Melodic note grouping

4 SOUND

Control speaker volume . Hi. Lo. Off.

Selected sound cue is still delivered through
headphone jack when speaker is off..

5 AUTO COMMAND

Engage or disengage USB connection to either or
both computers without rebooting.

Remotely control presentation software.

Actuators

POCKET - PC433AS

WEIGHT 3.7 oz.

SIZE 1.8" x 3.3" x 0.62".

Antenna extends 1.25".

POWER 2 "coin" lithium batteries
CR1632*

LASER < 1 watt; wavelength 650 nm



CONSOLE SIZE - PC433AL

WEIGHT 4.3 oz.

SIZE 1.8" x 3.3" x 0.62".

POWER 2 "coin" lithium
batteries CR1612*

LASER < 3 mW;
wavelength 650 nm



HARD-WIRED - PC433AH

WEIGHT 3.0 oz.

SIZE 1.8" x 3.3" x 0.62".

RANGE 12-foot cable

SETTING COMMUNICATIONS CHANNELS

Open the actuator cover by
unscrewing the mounting screw on
the underside.

Set DIP switch to match channel on
cue light.



REPLACEMENT BATTERIES

Please visit www.dsan.com/Batteries to order **free** replacement batteries.

Configurations

Remote signaling

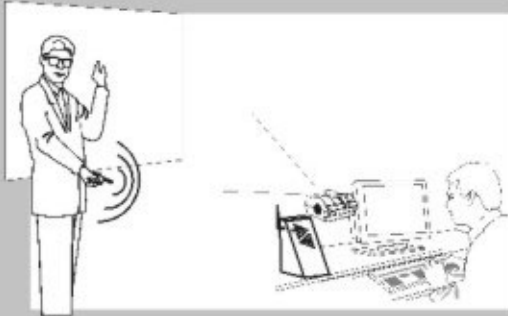

Remote signaling with feedback

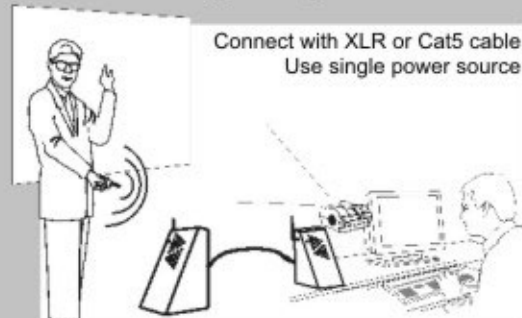

Remote software control

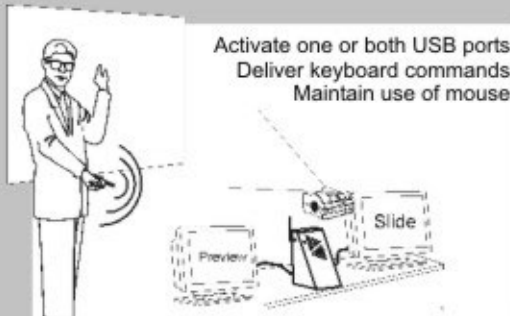

Custom devices control

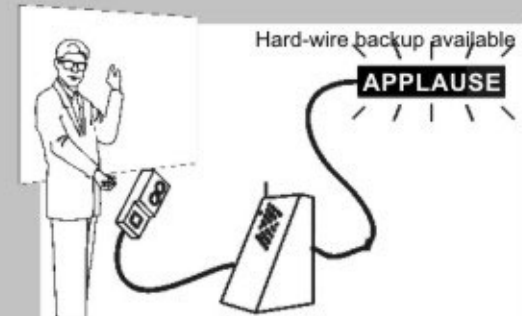

Multi-point signaling

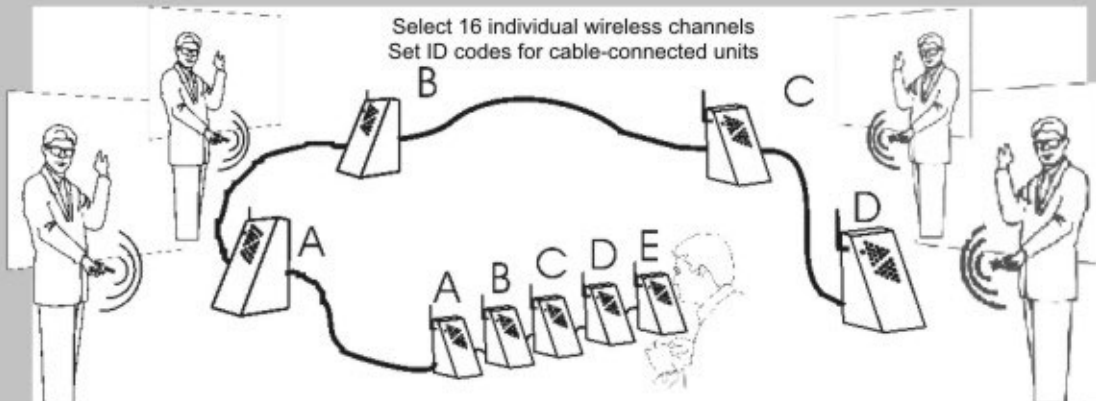

Unit E may be set to activate / respond to any or all other connected units via ID setting

Components and Accessories

PC-433SYS	Cue Light System. Includes cue light, small wireless actuator, power supply. Frequency: 433 Mhz
PC-433AS	Wireless actuator. Pocket size
PC-433AS1	Wireless actuator. Pocket size. 1 - button. "Next"
PC-433AS2	Wireless actuator. Pocket size. 2 - buttons. "Next," "Back."
PC-433AL	Wireless actuator. Console size

PC-433AH	Wireless actuator. Hard-wired. 12-ft cable.
PC-Sentry	Mini cue light designed to be affixed to front of computer screen
PC-Case	Carrying/storage case with custom foam cushion. Holds 2 PerfectCue Systems.
PC-433Kit	Two PerfectCue Systems and carrying/storage case.
PC-PW	12-volt wall-plug power supply. For 110 or 220-volt service.